

Hallam Senior College

Yard Duty and Supervision Policy



Help for non-English speakers

If you need help to understand the information in this policy please contact the school on [\(03\) 9703 1266](tel:0397031266) who will organise an interpreter.

PURPOSE

To ensure school staff understand their supervision and yard duty responsibilities.

SCOPE

This policy applies to all teaching and non-teaching staff at Hallam Senior College, including education support staff, casual relief teachers and visiting teachers.

POLICY

Appropriate supervision is an important strategy to monitor student behaviour and enables staff to identify and respond to possible risks at school as they arise. It also plays a vital role in helping schools to discharge their duty of care to students.

The Principal is responsible for ensuring that there is a well organised and responsive system of supervision and yard duty in place during school hours, before and after school, and on school excursions and camps and other school activities.

School staff are responsible for following reasonable and lawful instructions from the Principal, including instructions to provide supervision to students at specific dates, times and places. Supervision should be undertaken in a way that identifies and mitigates risks to child safety.

Before and after school

Hallam Senior College's grounds are supervised by school staff from 8.40am until 3.10pm. Outside of these hours, school staff will not be available to supervise students.

Before and after school, school staff will supervise the area surrounding the entrances of the school including; Gates 1, 2 and 3 and the bus bay that is outside the main reception area.

Students who wish to attend school outside of these hours will be expected to attend the library or their relevant year level study space.

Students attending class after these hours (e.g. for VET classes) are supervised by their teacher in the classroom and for breaks.

Yard duty

All staff at Hallam Senior College are expected to assist with yard duty supervision and will be included in the fortnightly roster.

The Principal and Daily Organiser are responsible for preparing and communicating the yard duty roster on a regular basis. At Hallam Senior College, school staff will be designated a specific yard duty area to supervise regularly and may also be given additional yard duties as extras which will be communicated with all staff daily.

Yard duty zones

The designated yard duty areas for our school as at Term 1 2022 are outlined below.

Zone	Area
Area 1	Oval and west side of Administration / Staff Carpark
Area 2	North and south internal courtyards / bus bay
Area 3	Rear basketball courts (south end of the school)
Area 4	East side portable classroom areas, adjacent grounds and student carpark.
Frawley Road gates 1, 2, 3	Gates / entrances as designated and adjacent paths.

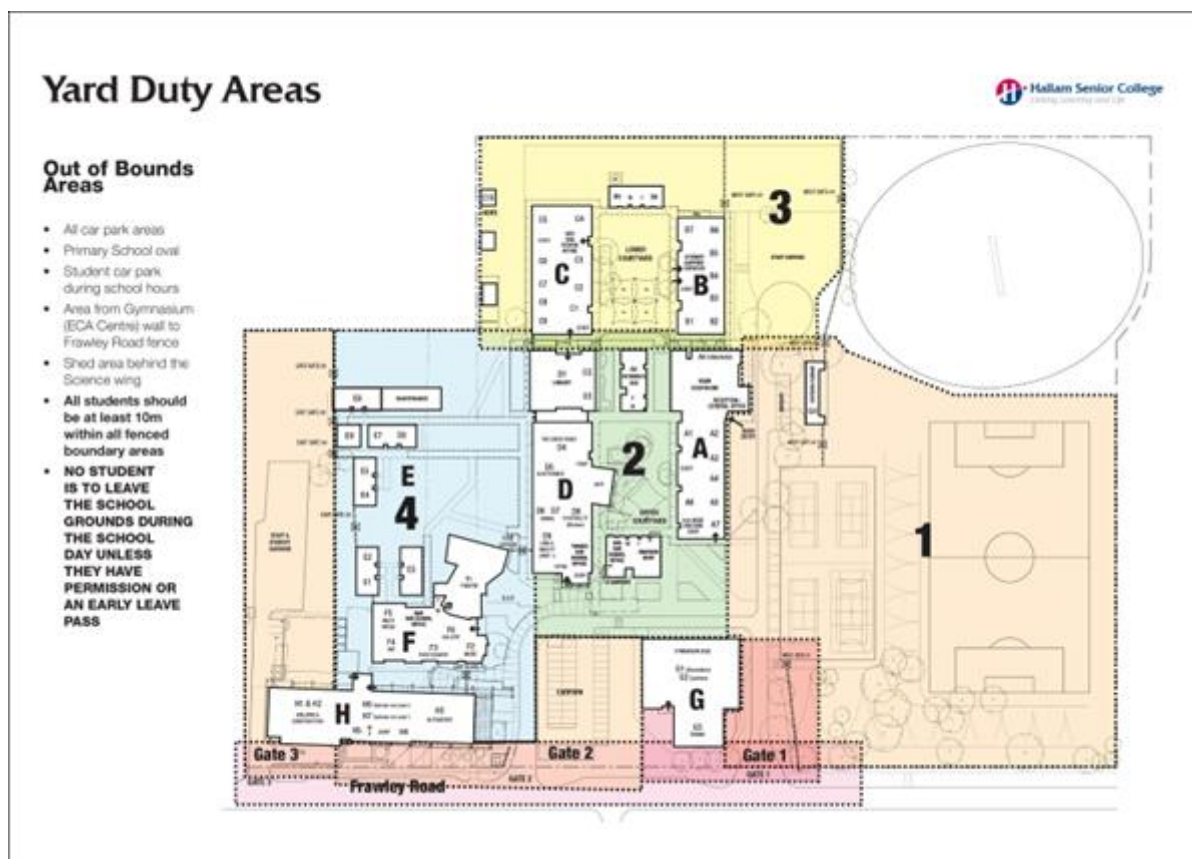

Yard duty equipment

School staff must:

- wear a provided safety/hi-vis vest whilst on yard duty. Safety/hi-vis vests will be stored in each of the staffrooms.

Yard duty responsibilities

Staff who are rostered for yard duty must remain in the designated area until they are replaced by a relieving staff member.

During yard duty, supervising school staff must:

- methodically move around the designated zone ensuring active supervision of all students. If you are on a gate duty, ensure you are positioned on the entry point so you can have a discussion with any students entering or leaving school grounds and ensure they are following school rules in relation to leaving school grounds
- where safe to do so, approach any unknown visitor who is observed on school grounds without a clear legitimate purpose, and ensure they have a visitor pass and have signed in (excluding drop off and collection periods)
- ensure students remain in their designated year level zones
- be alert and vigilant

- intervene immediately if potentially dangerous or inappropriate behaviour is observed in the yard
- enforce behavioural standards and implement appropriate consequences for breaches of safety rules, in accordance with any relevant disciplinary measures set out in the school's Student Engagement policy
- ensure that students who require first aid assistance receive it as soon as practicable
- log any incidents or near misses as appropriate on Compass

If being relieved of their yard duty shift by another staff member (for example, where the shift is 'split' into 2 consecutive time periods), the staff member must ensure that a brief but adequate verbal 'handover' is given to the relieving staff member in relation to any issues which may have arisen during the first shift.

If the supervising staff member is unable to conduct yard duty at the designated time, they should contact the daily organiser with as much notice as possible prior to the relevant yard duty shift to ensure that alternative arrangements are made.

If the supervising staff member needs to leave yard duty during the allocated time, they should contact the daily organiser but should not leave the designated area until the relieving staff member has arrived in the designated area.

If the relieving staff member does not arrive for yard duty, the staff member currently on duty should contact the administration office to locate the relieving staff member and not leave the designated area until a relieving staff member has arrived.

Students will be encouraged to speak to the supervising yard duty staff member if they require assistance during recess or lunchtime.

Classroom

The classroom teacher is responsible for the supervision of all students in their care during class.

If a teacher needs to leave the classroom unattended at any time during a lesson, they should first contact the front office or nearby staffroom for assistance. The teacher should then wait until a replacement staff member has arrived at the classroom before leaving.

School activities, camps and excursions

The Principal and leadership team are responsible for ensuring that students are appropriately supervised during all school activities, camps and excursions, including when external providers are engaged to conduct part or all of the activity. Appropriate supervision will be planned for school activities, camps and excursions on an individual basis, depending on the activities to be undertaken and the level of potential risk involved, and will follow the supervision requirements in the Department of Education and Training [Excursions Policy](#).

Digital devices and virtual classroom

Hallam Senior College follows the Department's [Cybersafety and Responsible Use of Technologies Policy](#) with respect to supervision of students using digital devices.

Students requiring additional supervision support

Sometimes students will require additional supervision, such as students with disability or other additional needs. In these cases, the Principal or delegate will ensure arrangements are made to roster additional staff as required. This may include on yard duty, in the classroom or during school activities.

Workplace learning programs

When students are participating in workplace learning programs, such as work experience, school-based apprenticeships and traineeships, and structured workplace learning, the safety and welfare of the student is paramount. Organising staff are required to follow all applicable Department of Education and Training policies and guidelines in relation to off-site learning, including policy and guidelines on the safety and wellbeing of students. Refer to:

- [Structure Workplace Learning](#)
- [School Based Apprenticeships and Traineeships](#)
- [Work Experience](#)
- [School Community Work](#)

Independent Study

Year 11 or 12 students must present to their relevant study areas during their timetabled study blocks where teacher supervision and support will be provided. Students will not be permitted to leave school grounds during these sessions.

Supervision of student in emergency operating environments

In emergency circumstances our school will follow our Emergency Management Plan, including with respect to supervision.

In the event of any mandatory period of remote or flexible learning our School will follow the operations guidance issued by the Department.

COMMUNICATION

This policy will be communicated to our school community in the following ways

- Included in staff induction processes
- Discussed at staff briefings or meetings, as required
- Included in our staff handbook
- Included as a reference in our school newsletter each term
- Made available in hard copy from school administration upon request

Information for parents and students on supervision before and after school is available on our school website and parent reminders are sent at the beginning of each term in our school newsletter.

FURTHER INFORMATION AND RESOURCES

- the Department's Policy and Advisory Library (PAL):



Hallam Senior College
Linking Learning and Life

- [Child Safe Standards](#)
- [Cybersafety and Responsible Use of Technologies](#)
- [Duty of Care](#)
- [Excursions](#)
- [School Based Apprenticeships and Traineeships](#)
- [School Community Work](#)
- [Structured Workplace Learning](#)
- [Supervision of Students](#)
- [Visitors in Schools](#)
- [Work Experience](#)

POLICY REVIEW AND APPROVAL

Policy last reviewed	June 2022
Approved by	Principal
Next scheduled review date	June 2024

This policy will also be updated if significant changes are made to school grounds that require a revision of Hallam Senior College's yard duty and supervision arrangements.